

# BANK OF AMERICA BUILDING

102 N Broad Street | Winder, GA 30680



**OFFICE SPACES FOR LEASE | TWO SPACES AVAILABLE**

Located in a Premier Retail  
Corner in Downtown Winder, GA

**MATTHEWS™**

# EXCLUSIVELY LISTED BY



**Parker Hammond**

Associate

**(404) 905-6526**

[parker.hammond@matthews.com](mailto:parker.hammond@matthews.com)

License No. 449029 (GA)



**Lily H. Heimburger**

Senior Vice President

**(404) 905-5629**

[lily.heimburger@matthews.com](mailto:lily.heimburger@matthews.com)

License No. 260232 (GA)



**Adrienne Crawford**

Senior Vice President

**(404) 905-5719**

[adrienne.crawford@matthews.com](mailto:adrienne.crawford@matthews.com)

License No. 303241 (GA)

## Broker of Record

Maxx Bauman

License No. 451849 (GA)

Firm No. 80041 (GA)

# MATTHEWS™



# WINDER, GA

Winder, Georgia is a growing Barrow County community positioned between Atlanta and Athens, offering access to major employment centers and the lifestyle benefits of a college-oriented region. **Located approximately 30 minutes from downtown Athens and the University of Georgia**, the area has a strong presence of UGA alumni, with **Barrow County ranking among the top counties in Georgia per capita for University of Georgia alumni**. As part of the Atlanta MSA, many residents commute to Gwinnett County and metro Atlanta while benefiting from a more accessible suburban setting.

The area combines the advantages of being within the Atlanta MSA with the benefits of proximity to a major SEC university and regional economic hub.

Winder serves as the county seat of Barrow County and continues to see growth supported by manufacturing, healthcare, and retail sectors. **Major industrial employers include the Johns Manville plant and Olympic Steel facility**, while the community is also **situated just north of Fort Yargo State Park, a major recreational destination in northeast Georgia**.

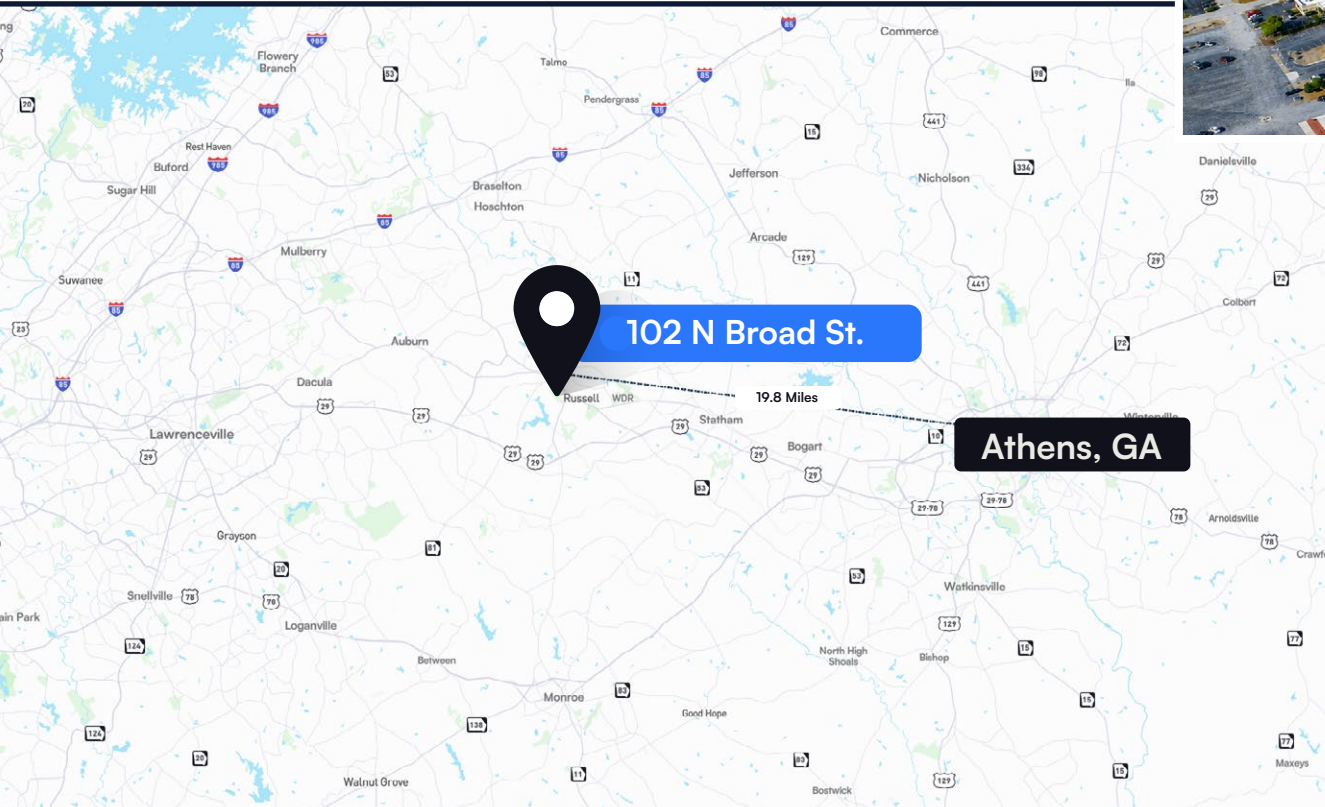

## DEMOGRAPHICS

	3-MILE	5-MILE
<b>POPULATION</b>		
2025 Population	7,868	51,741
2030 Population Projection	8,849	58,572
<b>HOUSEHOLDS</b>		
2025 Households	2,999	17,930
2030 Household Projection	3,373	20,305
<b>INCOME</b>		
Avg Household Income	\$57,392	\$86,113
Annual Consumer Spending	\$68.8M	\$562.7M





Winder Legacy Park



Subject Property



± 22,300 VPD

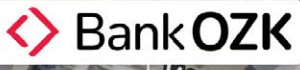

# PROPERTY HIGHLIGHTS

- **Downtown Winder Location:** Strategically located adjacent to historic downtown Winder and the vibrant Winder Entertainment District, a well-trafficked destination for dining, retail, and social activity.
- **Strong Traffic Counts:** Positioned along a highly visible corridor with traffic counts exceeding 20,000 vehicles per day.
- **Existing Monument Signage:** Property includes an existing pylon sign, providing prominent visibility and immediate branding opportunities for future tenancy.
- **Move-In Ready Office Buildout:** Existing office improvements are in place, allowing for immediate occupancy and reduced upfront tenant costs.
- **Located in a growing Barrow County:** New developments including Barrow Crossing, Publix at Winder Hill, and The Gateway at University Parkway.

## 2008 Barrow Crossing Shopping Center

Largest retail center in Barrow County including Target, Belk, Michaels, T.J. Maxx, Publix, and many more destination retail locations.

## 2022 Publix at Winder Hill

Delete Publix information from highlights and include here.

## 2011-Present The Gateway at University Parkway

Mixed use development including entertainment, retail, medical, hospitality, and multifamily projects.



# SITE PLAN

---

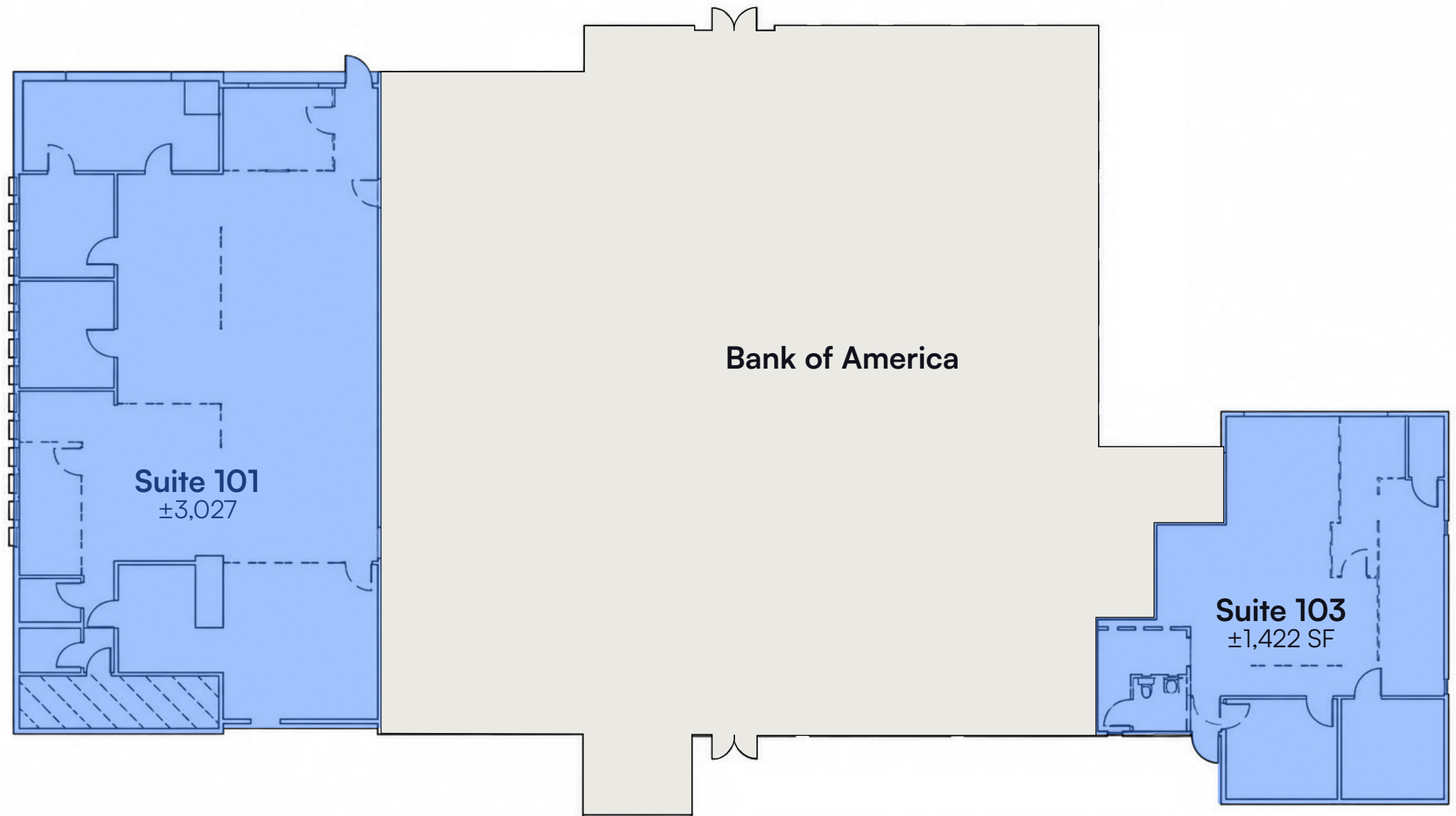

# UNIT 101



# UNIT 103



# BANK OF AMERICA BUILDING

102 N Broad St | Winder, GA 30680

EXCLUSIVELY LISTED BY

**Parker Hammond**

Associate

**(404) 905-6526**

[parker.hammond@matthews.com](mailto:parker.hammond@matthews.com)

License No. 449029 (GA)

**Lily H. Heimburger**

Senior Vice President

**(404) 905-5629**

[lily.heimburger@matthews.com](mailto:lily.heimburger@matthews.com)

License No. 260232 (GA)

**Adrienne Crawford**

Senior Vice President

**(404) 905-5719**

[adrienne.crawford@matthews.com](mailto:adrienne.crawford@matthews.com)

License No. 303241 (GA)

**MATTHEWS™**

This Leasing Package contains select information pertaining to the business and affairs located at 102 N Broad St | Winder, GA 30680 ("Property"). It has been prepared by Matthews™. This Leasing Package may not be all-inclusive or contain all of the information a prospective lessee may desire. The information contained in this Leasing Package is confidential and furnished solely for the purpose of a review by a prospective lessee of the Property. The material is based in part upon information supplied by the Owner. Owner, nor their officers, employees, or agents makes any representation or warranty, express or implied, as to the accuracy or completeness of this Leasing Package or any of its contents and no legal liability is assumed or shall be implied with respect thereto. Prospective lessees should make their own projections and form their own conclusions without reliance upon the material contained herein and conduct their own due diligence. Owner and Matthews™ expressly reserve the right, at their sole discretion, to reject any and all expressions of interest or offers to lease the Property and to terminate discussions with any person or entity reviewing this Leasing Package or making an offer to lease the Property unless and until a lease has been fully executed and delivered. In no event shall a prospective lessee have any other claims against Owner or Matthews™ or any of their affiliates or any of their respective officers, Directors, shareholders, owners, employees, or agents for any damages, liability, or causes of action relating to this solicitation process or the marketing of the Property. This Leasing Package shall not be deemed to represent the state of affairs of the Property or constitute an indication that there has been no change in the state of affairs of the Property since the date this Leasing Package.